



ACCESSORI
VETRO
GLASS
ACCESSORIES

**ACCESSORI TOTALMENTE
PRODOTTI IN ITALIA**
TOTALLY MADE IN ITALY
GLASS ACCESSORIES



NUOVO DESIGN CURVATO
NEW CURVED DESIGN

TRUMP®
Garda
ACCESSORI



 **SPECIFICHE MATERIALI:**

- FUSIONI in Lega Vergine di Alluminio EN AB 46000 con marchio MADE IN ITALY in rilievo
- COPERTINE in acciaio Inox AISI-304 PF2B 10/10 disponibili SATINATE, LUCIDATE o rivestite PVD (Physical Vapour Deposition) finitura ORO marchio MADE IN ITALY all'interno. Optional copertine in acciaio inox AISI 316L
- INSERTI in lega di Ottone OT58 stampata a caldo marchiati MADE IN ITALY
- GUARNIZIONI in FASIT R 202 - ISO 9001 - DIN 3754 Materiale gommoso composito, SENZA AMIANTO, DIN 3754 resistenza al calore 160°
- VITERIA in Acciaio al carbonio 10,9 DIN 965,7991 Trattamento DACROMET® Superficiale (oltre 350/hrs. in camera di nebbia salina)

 **MATERIALS SPECIFY:**

- BODY in die casted pure vergin aluminium alloy, Grade EN AB 46000, engraved MADE IN ITALY
- COVERS in stainless steel AISI-304 PF2B 10/10 (available POLISHED, SATIN or GOLD PVD coated) Mark MADE IN ITALY inside. Optional covers in stainless steel AISI 316L
- INSERTS Hot Stamped Brass OT58, stamped MADE IN ITALY
- GASKETS in FASIT R 202 - ISO 9001 - DIN 3754 Composite Rubber Material, ASBESTOS FREE, DIN 3754 heat resistance up to 160°
- SCREW carbon steel 10,9 DIN 965, 7991 DACROMET® treatments (350/hrs. salt spray test)



NUOV● DESIGN CURVAT● CON FISSAGGI● INNOVATIV●
NEW CURVED DESIGN PATCH FITTING INNOVATIVE



 Marchio **MADE IN ITALY** e **TOP GARDA** in rilievo sulle fusioni

 *MADE IN ITALY* and *TOP GARDA* mark engraved onto body



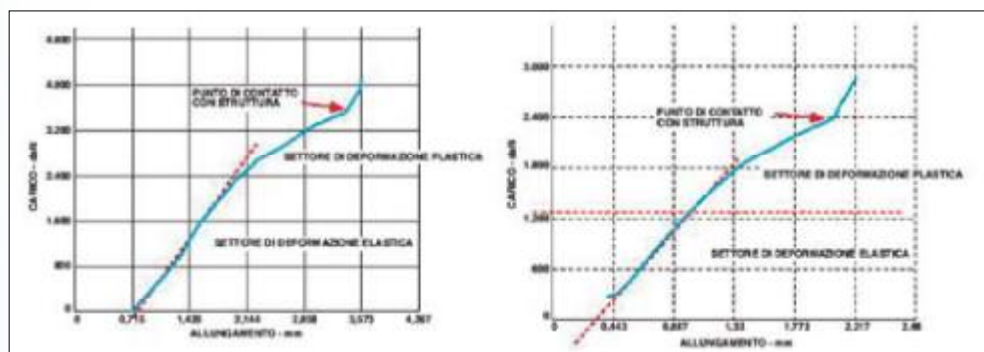

- **GARDA TO E GARDA BO. La prova evidenzia le tre fasi:**
 1. Elastica: dove il pezzo sottoposto ad un determinato sforzo non subisce nessuna alterazione
 2. Plastica: dove il pezzo sottoposto ad un determinato sforzo subisce una deformazione
 3. Rottura: dove il pezzo sottoposto ad un determinato sforzo subisce la rottura
- **GARDA TO AND GARDA BO. This test highlights the three phases:**
 1. Elastic: where the item under a given load will not modify its shape
 2. Plastic: where the item under a given load will modify its shape permanently
 3. Breakage: where the item under a given load will break

■ ■ Le certificazioni per i carichi di rottura delle fusioni sono state eseguite dalla ditta CPM Gruppo APAVE di BIENNO (BS) organismo notificato CE - 0398, con test n° 1971 e, come illustrato dai grafici, le fusioni raggiungono i 2400 N (TO) ed i 3600 N (BO) flettendo senza rotture.

■ The above tests (made by CPM APAVE Group di BIENNO (BS) CE-0398 Notified) were carried out to determine the maximum weight the hinges would stand. The results were that 2 insert bended, without breaking, when the pressure on the bottom hinge (BO) reached 3600N and 2400N on bottom hinge (BO).

A RICHIESTA RAPPORTO COMPLETO DI TEST

COMPLETE TEST REPORTS AVAILABLE ON REQUEST



**C.P.M.
ISTITUTO RICERCHE PROVE ANALISI s.r.l.**

25040 BIENNO (BS) - Via Artigiani, 63 - Tel. 0364.300342 - Fax 0364 300354

ORGANISMO NOTIFICATO - **CE** 0398



BO**CERNIERA INFERIORE
BOTTOM HINGE****FINITURE SUPERFICIALI**

- acciaio inox LUCIDATO
- acciaio inox SATINATO
- acciaio inox PVD ORO

Disponibile anche con Inserto
RETTANGOLARE Tedesco
(cod: 46025)

SURFACE FINISHING

- stainless steel POLISHED
- stainless steel SATIN
- stainless steel GOLD PVD

Also Available with
RECTANGULAR German Insert
(code: 46025)

Vetro: 10-12 mm
Porta L: 1200 mm
Peso Max: 3600 N

Glass: 10-12 mm
Door L: 1200 mm
Max Weight: 3600 N

Interasse: 53 – 66 mm
Centerline: 53 – 66 mm

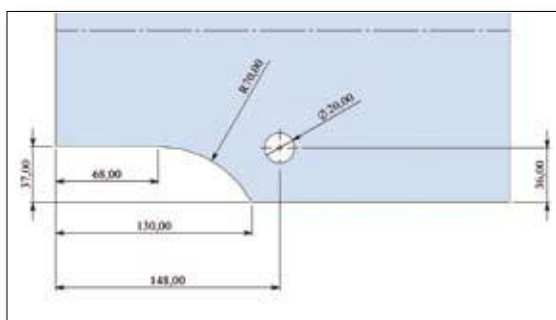
**TO****CERNIERA SUPERIORE
TOP HINGE****FINITURE SUPERFICIALI**

- acciaio inox LUCIDATO
- acciaio inox SATINATO
- acciaio inox PVD ORO

SURFACE FINISHING

- stainless steel POLISHED
- stainless steel SATIN
- stainless steel GOLD PVD

Vetro: 10-12 mm
Porta L: 1200 mm
Peso Max: 2400 N

Glass: 10-12 mm
Door L: 1200 mm
Max Weight: 2400 N

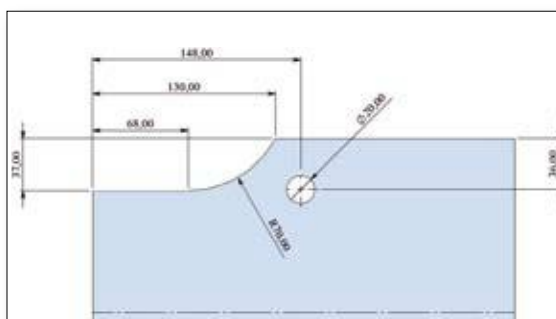

Interasse: 53 – 66 mm
Centerline: 53 – 66 mm



FINITURE SUPERFICIALI

- acciaio inox LUCIDATO
- acciaio inox SATINATO
- acciaio inox PVD ORO

SURFACE FINISHING

- stainless steel POLISHED
- stainless steel SATIN
- stainless steel GOLD PVD



cod: 46026

Vetro: 10-12 mm
Glass: 10-12 mm

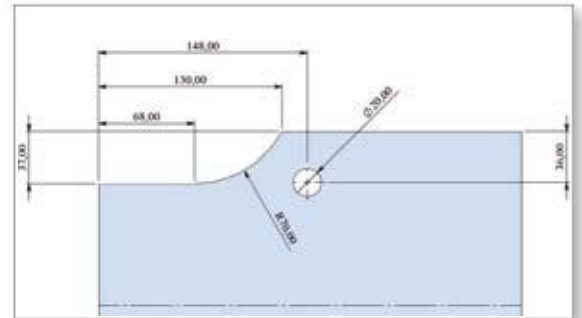

FINITURE SUPERFICIALI

- acciaio inox LUCIDATO
- acciaio inox SATINATO
- acciaio inox PVD ORO

SURFACE FINISHING

- stainless steel POLISHED
- stainless steel SATIN
- stainless steel GOLD PVD

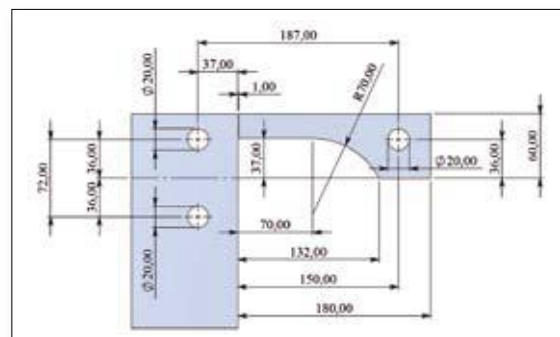

Vetro: 10-12 mm
Glass: 10-12 mm

FINITURE SUPERFICIALI

- acciaio inox LUCIDATO
- acciaio inox SATINATO
- acciaio inox PVD ORO

SURFACE FINISHING

- stainless steel POLISHED
- stainless steel SATIN
- stainless steel GOLD PVD

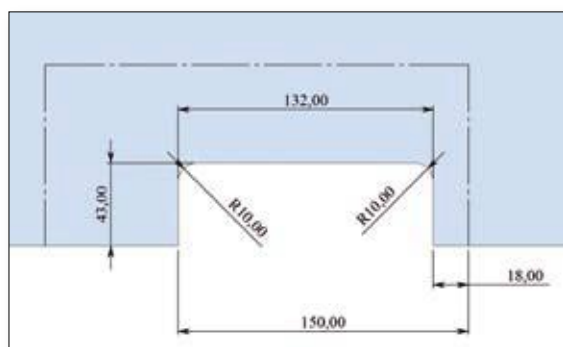

Vetro: 10-12 mm

Glass: 10-12 mm

FINITURE SUPERFICIALI

- acciaio inox LUCIDATO
- acciaio inox SATINATO
- acciaio inox PVD ORO

SURFACE FINISHING

- stainless steel POLISHED
- stainless steel SATIN
- stainless steel GOLD PVD

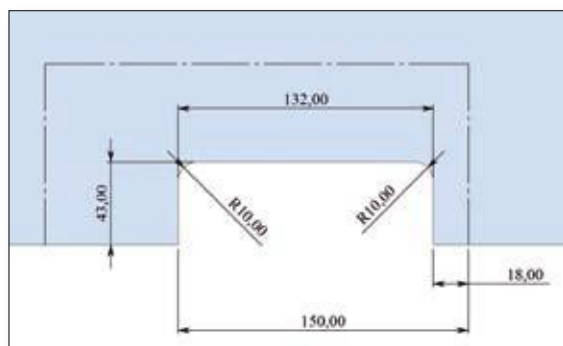

Vetro: 10-12 mm

Glass: 10-12 mm

FINITURE SUPERFICIALI

- acciaio inox LUCIDATO
- acciaio inox SATINATO
- acciaio inox PVD ORO

SURFACE FINISHING

- stainless steel POLISHED
- stainless steel SATIN
- stainless steel GOLD PVD

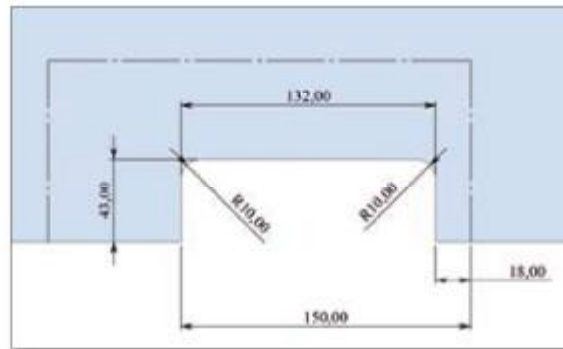

Vetro: 10-12 mm
Glass: 10-12 mm

FINITURE SUPERFICIALI

- acciaio inox LUCIDATO
- acciaio inox SATINATO
- acciaio inox PVD ORO

SURFACE FINISHING

- stainless steel POLISHED
- stainless steel SATIN
- stainless steel GOLD PVD

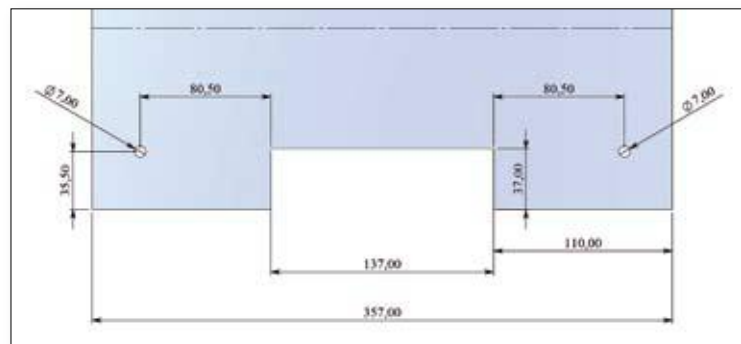

Vetro: 10-12 mm
Glass: 10-12 mm

TKL

CHIAVISTELLO TURN KNOB LOCK

FINITURE SUPERFICIALI

- acciaio inox LUCIDATO
- acciaio inox SATINATO
- acciaio inox PVD ORO

SURFACE FINISHING

- stainless steel POLISHED
- stainless steel SATIN
- stainless steel GOLD PVD

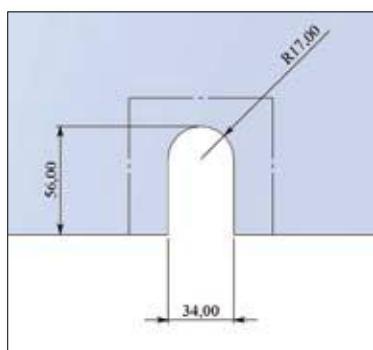

Vetro: 10-12 mm

Glass: 10-12 mm

TKK

CONTROCHIAVISTELLO TURN KNOB KEEPER

FINITURE SUPERFICIALI

- acciaio inox LUCIDATO
- acciaio inox SATINATO
- acciaio inox PVD ORO

SURFACE FINISHING

- stainless steel POLISHED
- stainless steel SATIN
- stainless steel GOLD PVD

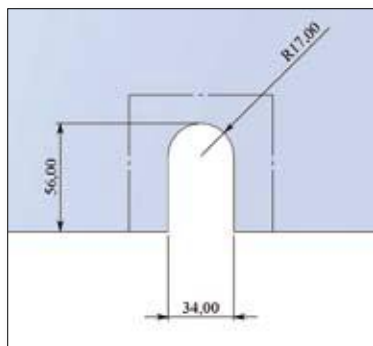

Vetro: 10-12 mm

Glass: 10-12 mm

 **FINITURE SUPERFICIALI**

- acciaio inox LUCIDATO
- acciaio inox SATINATO
- acciaio inox PVD ORO

 **SURFACE FINISHING**

- stainless steel POLISHED
- stainless steel SATIN
- stainless steel GOLD PVD



Vetro: 10-12 mm
Glass: 10-12 mm

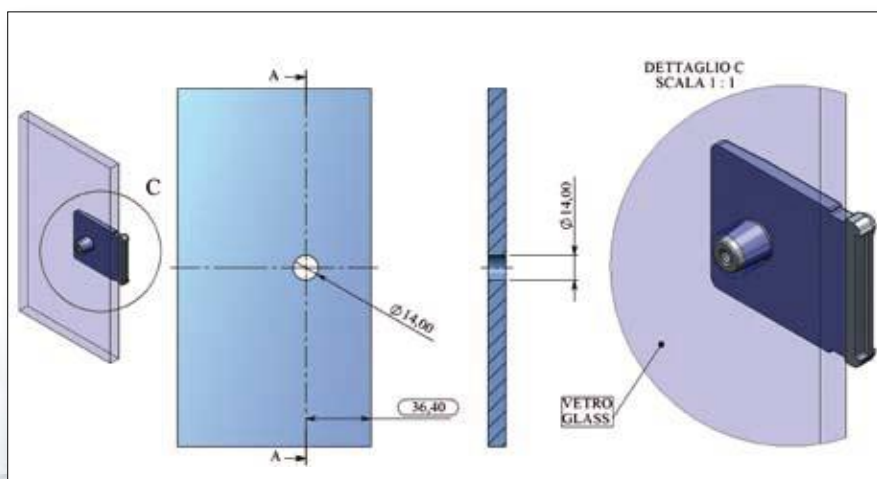

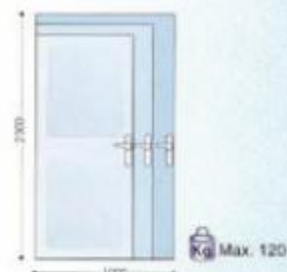
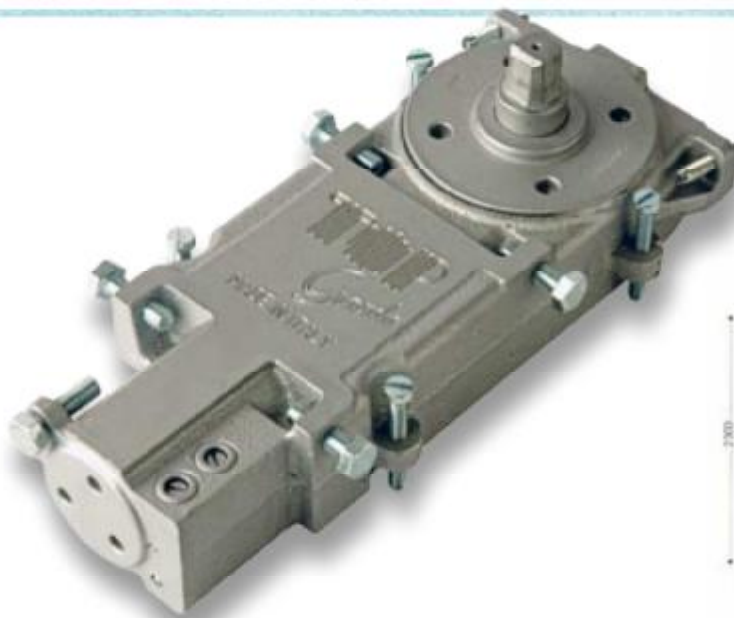

CARATTERISTICHE:

- Corpo in ghisa.
- Universale per porte destre, sinistre e a ventola.
- Adatto per porte in legno, metallo, vetro.
- Fermaporta 90°, 110° o multipunto tra 110° e 180° (effetto cerniera).
- Regolazione in tutti i sensi per risolvere facilmente problemi di complanarità del pavimento senza necessità di smontare la porta.
- Ampia regolazione verticale (20 mm.) per eliminare ogni attrito al suolo senza necessità di prolunghe del perno, o per montaggio sotto moquette.
- Apertura consentita fino a 180° nei due sensi con richiamo idraulico da circa 110°. Rotazione libera da 110° a 180°.
- Velocità di chiusura controllata da due valvole indipendenti non critiche di facile regolazione.
- Chiusura dolce o con potente scatto finale regolato da valvola per assicurare il tipo di chiusura più adatto.
- Ampia gamma di finiture della piastra di copertura: inox lucido, inox satinato.
- Disponibile con perno italiano o tedesco.

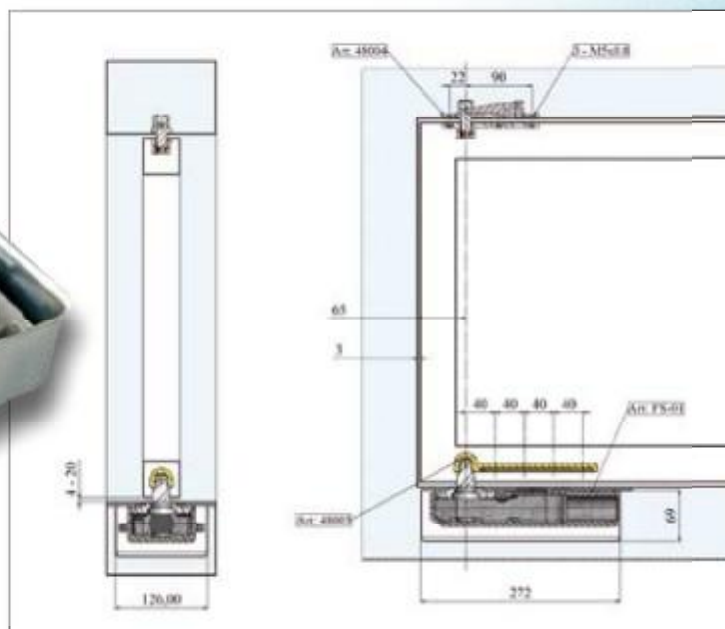

FEATURES:

- Cast iron body.
- Universal for right, left or double action doors.
- Suitable for timber, metal and glass doors.
- Hold open at 90°, 110° or multipoint 110°- 180° (hinge effect).
- Adjustment directions to solve floor level problems without taking down the door.
- Wide range of vertical adjustment (20 mm.) to solve problems of undue door friction without need of additional spindle extensions, or for mounting underneath carpeted floors.
- Opening up to 180° in both swings with hydraulic control from approx 110°. Free rotation from 110° to 180°.
- Closing speed controlled by two easily adjustable independent non critical valves.
- Soft closing or powerful latching action to ensure proper closing also in case of hard-to-latch locks.
- Architectural finishes: coverplates in polished stainless steel, satin stainless steel.
- Available with Italian or German spindle.





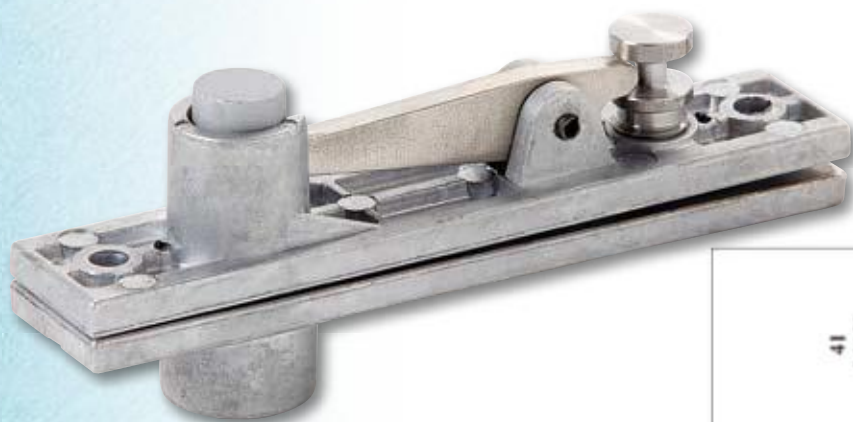
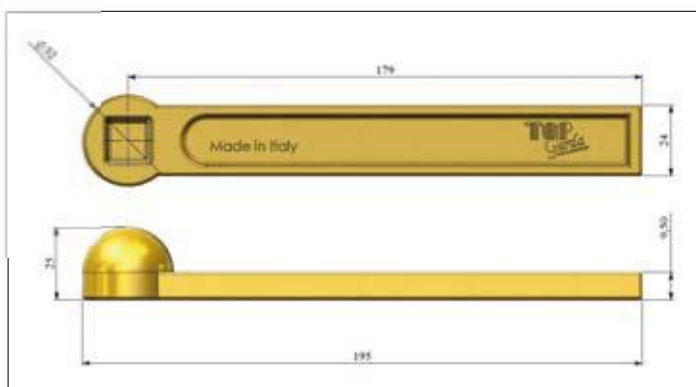

Cod. 48003

-  Braccio inferiore in ottone per porta a ventola. Quadro italiano.
-  Bottom arm in brass for double acting doors. Square italian spindle.



Cod. 48004

-  Perno superiore per porta a ventola
-  Double acting top pivot

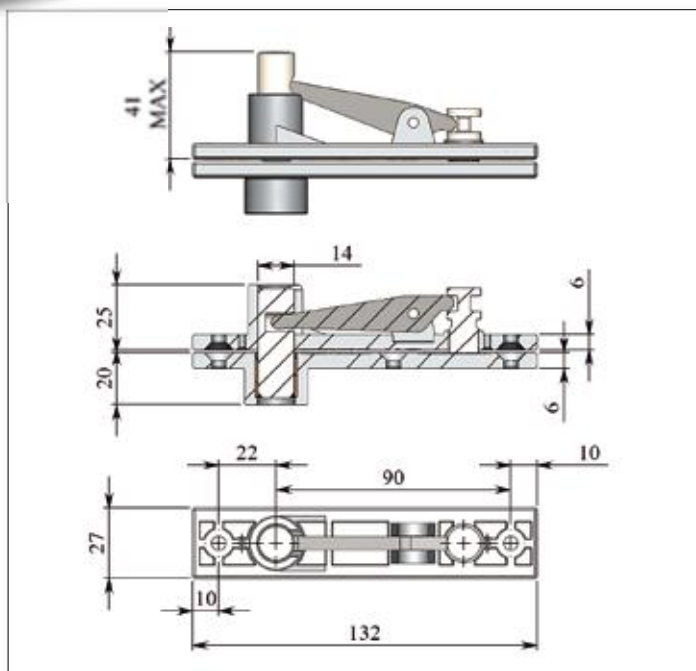

MANIGLIONI SENZA SERRATURA HANDLES WITHOUT LOCK



Cod. 347

 **FINITURA:** lucida
MATERIALE: inox 304
DIMENSIONI: Ø 25 mm
 L: 450 mm
 C: 305 mm

 **FINISHING:** polished
MATERIAL: stainless steel 304
DIMENSIONS: Ø 25 mm
 L: 450 mm
 C: 305 mm

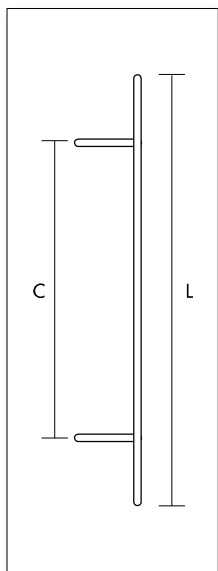

Cod. 143

 **FINITURA:** lucida e satinata
MATERIALE: inox 304
DIMENSIONI: Ø 32 mm
 L: 600 mm
 C: 568 mm

 **FINISHING:** polished & satin
MATERIAL: stainless steel 304
DIMENSIONS: Ø 32 mm
 L: 600 mm
 C: 568 mm

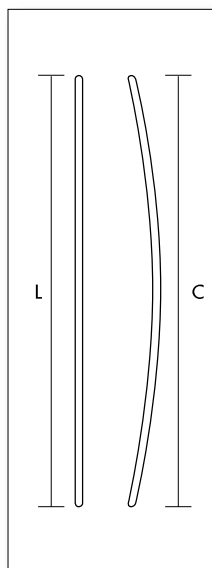

Cod. 112

 **FINITURA:** lucida
MATERIALE: inox 304
DIMENSIONI: Ø 32 mm
 L: 1200 mm
 C: 1000 mm

 **FINISHING:** polished
MATERIAL: stainless steel 304
DIMENSIONS: Ø 32 mm
 L: 1200 mm
 C: 1000 mm

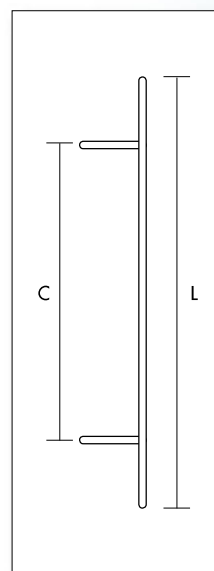





KIT GUARNIZIONI GASKETS KIT

FASIT R 202 - ISO 9001 - DIN 3754





Cod. 46063sx + 46064dx

-  Kit 2 guarnizioni per LK / LO / LOL
-  Kit 2 gaskets for LK / LO / LOL

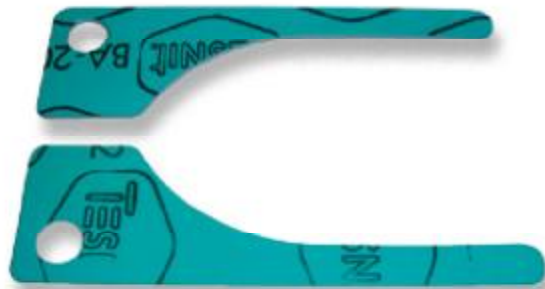
-  Materiale gommoso composito, SENZA AMIANTO, DIN 3754 resistenza al calore 160°
-  Composite rubber material, ASBESTOS FREE, DIN 3754 heat resistance up to 160°





Cod. 46062sx + 46061dx

-  Kit 2 guarnizioni per BO / TO / TOW
-  Kit 2 gaskets for BO / TO / TOW





Cod. 46058 / 46059

-  Kit 2 guarnizioni per TKL / TKK
-  Kit 2 gaskets for TKL / TKK



Cod. 46062sx + 46061dx + (2) 46060

-  Kit 4 guarnizioni per OS kit
-  Kit 4 gaskets for OS

- Spessori disponibili:
- 1 mm (per vetro 10-12 mm)
 - 2 mm (per vetro 8-10 mm)

- Available Thickness:
- 1 mm (for 10-12 mm Glass)
 - 2 mm (for 8-10 mm Glass)

INSERTI REGOLABILI ADJUSTABLE INSERT



Cod. 46020

 Insetto con perno per OS

 Insert with pin for OS



Cod. 46025

 Insetto con foro rettangolare tedesco

 German rectangular hole insert

Cod. 46022/C

 Insetto con bronzina in bronzo
Sinterizzato

 Insert with bush made in sintered bronze



Cod. 46024

 Insetto con foro quadro

 Italian square hole insert



Cod. 46010

 Serratura con perno di sezione rettangolare

 *Rectangular section lock*



Cod. 46010/CIL

 Serratura con perno a sezione cilindrica

 *Cylindrical section lock*



Cod. 46030

 Kit cilindro + 3 chiavi sinterizzato

 *Cylinder + 3 keys kit*

ACCESSORI DI FISSAGGI
FIXING ACCESSORIES



 **Cod. TO-PL**
 Perno a muro per cerniera TO

 **Cod. TO-PL**
 Wall pin for TO hinge

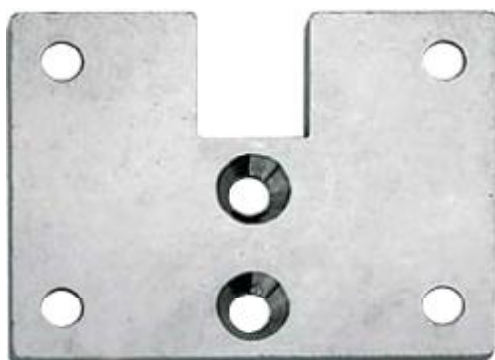

 **Cod. 46026**
 Piastrina per fissaggio
 muro cerniera TOW

 **Cod. 46026**
 Fixing plate for TOW hinge

ACCESSORI PER PAVIMENTI
FLOOR ACCESSORIES

Cod. 48001

 **PILETTA A TERRA per BO**
 Base diam. 20 mm
 Altezza 34 mm
 Diam. testa 30x2(h) mm

 **FLOOR PIVOT for BO**
 Base diam. 20 mm
 Height 34 mm
 Head diam. 30x2(h) mm



Cod. 48002

 **POZZETTO PER SERRATURA per TKL e LOL**
 Base diam. 19 mm
 Altezza 40 mm
 Diam. testa 25x4(h) mm.

 **FLOOR LOCK KEEPER for TKL and LOL**
 Base diam. 19 mm
 Height 40 mm
 Head diam. 25x4(h) mm



ACCESSORI VETRO GLASS ACCESSORIES

- 1. Acciaio Inox LUCIDATO
- 2. Rivestimento PVD oro
- 3. Acciaio Inox SATINATO

- 1. POLISHED Stainless Steel
- 2. Gold PVD coating
- 3. SATIN Stainless Steel

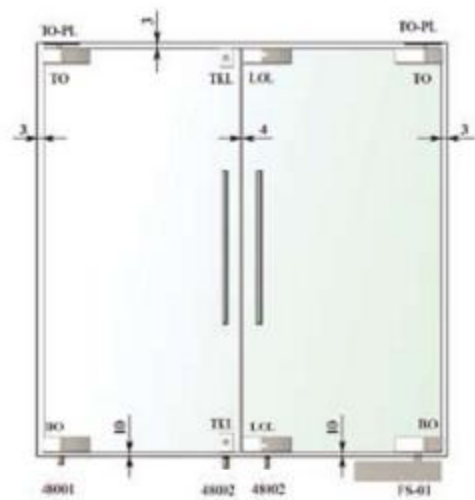
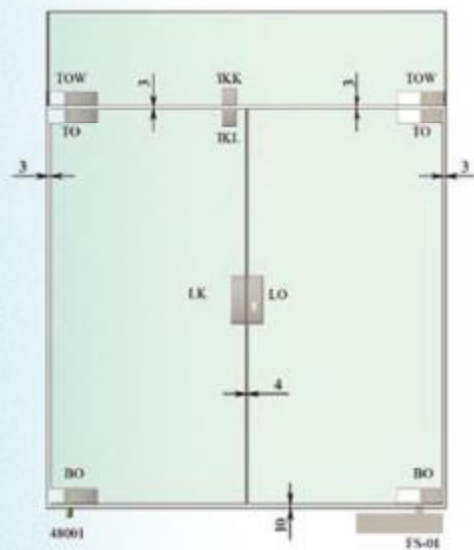
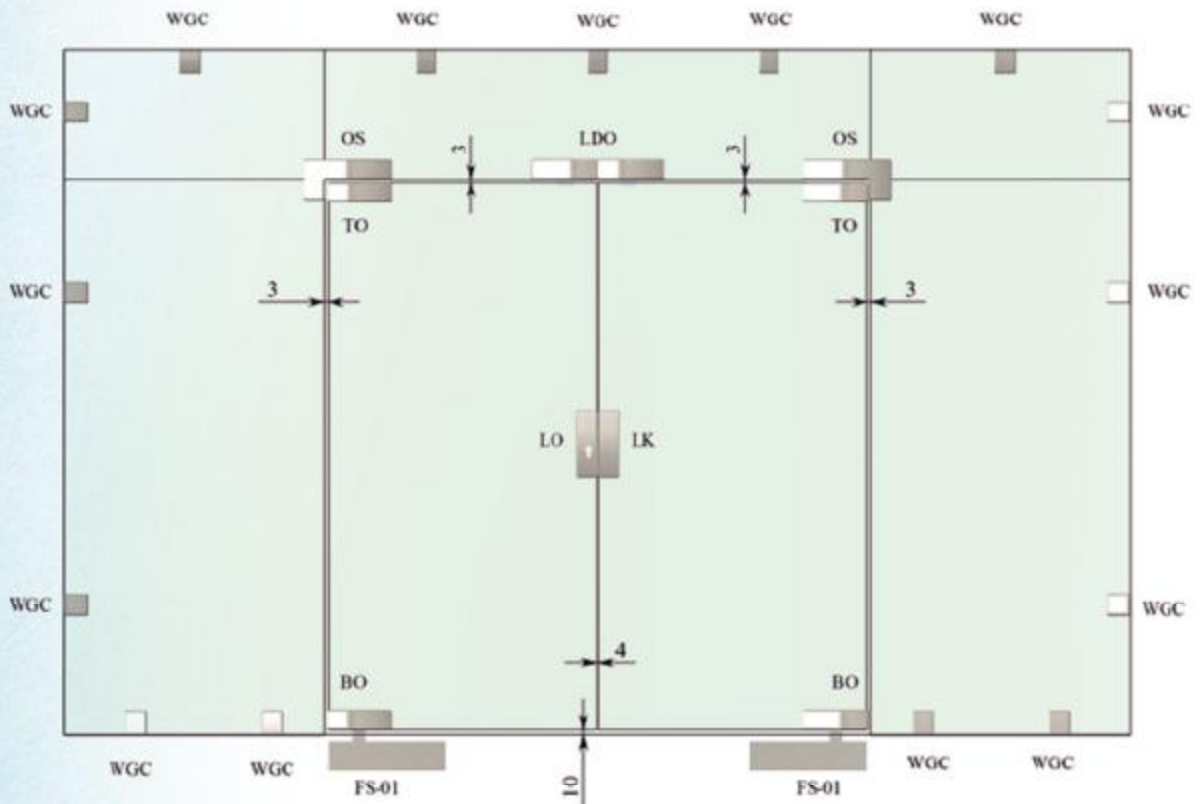
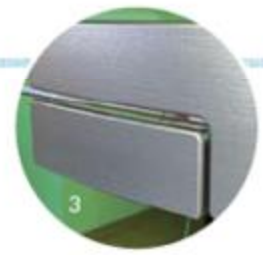
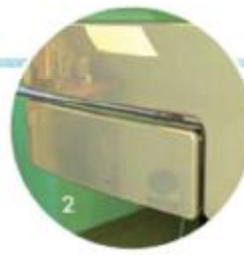
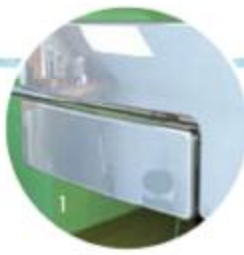



TOP GARDA S.R.L.
27040 MEZZANINO - PAVIA - ITALIA
VIA MALPENSATA DI SOTTO, 23
TEL. +39.0385. 71067 R.A.
FAX +39.0385. 71417
INFO@TOPGARDA.IT
WWW.TOPGARDA.IT